



# KMSR Series

Single Phase Solid State Relays



- Hockey puck style single phase SSR
- LED indicator of the control input status
- Clip cover of IP20 touch protection
- Available 4 ~ 32VDC or 90 ~ 265VAC input

## Specifications

Insulation Resistance	100MΩ/500VDC (btwn Terminal & Case)
Dielectric Strength	2500VAC(50/60Hz 1minute)
Vibration Resistance	10-55Hz, amplitude: 1.5mm,x,y,z each axis 2 hours
Shock Resistance	1000m/s <sup>2</sup> ,s,y,z each axis 3times
Storage Temperature	-30°C~ +90°C
Ambient Temperature	-25°C~ +70°C
Ambient Humidity	45 - 85% R.H
Weight	approx. 100g

## Ordering Information

**KMSR -** ① ② ③ ④

① Input Voltage	<b>D</b>	4 - 32 VDC	
	<b>A</b>	90 - 265 VAC	
② Output Voltage	<b>S</b>	Single Phase	
	<b>D</b>	DC	
③ Load Current			
<b>005</b>	5A*	<b>040</b> 40A	
<b>010</b>	10A	<b>050</b> 50A	
<b>020</b>	20A	<b>060</b> 60A	
<b>025</b>	25A	<b>100</b> 100A	
<b>030</b>	30A		
④ Load Voltage	<b>AC</b>	2	90 - 240V
		4	90 - 480V
	<b>DC</b>	5	50V

\*DC output type only  
- DC Output DC Input models are not available

## Characteristics

### DC Input / AC Output (90 - 240VAC) .9A

Model#	KMSR-	DS0102	DS0202	DS0252	DS0302	DS0402	DS0502	DS0602	DS1002
Input	Rated Control Voltage	4 - 32VDC							
	Pick-up Voltage	3VDC Minimum							
	Drop-out Voltage	1.5VDC Maximum							
	Input Current	3-35mA							
Output	Rated Load Voltage	90 - 240VAC							
	Peak Voltage	600V						800V	
	Rated Load Current	10A	20A	25A	30A	40A	50A	60A	100A
	Frequency	47 - 63Hz							
	Single Cycle Surge Current Resistance	170A	250A	315A			580A		
	Output Leakage Current (Maximum)	10mA	15mA						
	Output on Voltage Drop	1.5V Maximum							
	Minimum Switching Current	1A							
	Pick-up/Drop-out Time	1/2 cycle+1ms Maximum							

### DC Input / AC Output (90 - 480VAC) .9A

Model#	KMSR-	DS0104	DS0204	DS0254	DS0304	DS0404	DS0504	DS0604	DS1004
Input	Rated Control Voltage	4 - 32VDC							
	Pick-up Voltage	3VDC Minimum							
	Drop-out Voltage	1.5VDC Maximum							
	Input Current	3 - 35mA							
Output	Rated Load Voltage	90 - 480VAC							
	Peak Voltage	800V	1200V						
	Rated Load Current	10A	20A	25A	30A	40A	50A	60A	100A
	Frequency	47 - 63Hz							
	Single Cycle Surge Current Resistance	170A	250A	350A	370A	580A			
	Output Leakage Current (Maximum)	20mA							
	Output on Voltage Drop	1.3V MAX	1.6V MAX	1.8V Maximum					
	Minimum Switching Current	1A							
Pick-up/Drop-out Time	1/2 cycle+1ms Maximum								

**AC Input / AC Output (90 - 240VAC)**

Model#	KMSR-	AS0102	AS0202	AS0252	AS0302	AS0402	AS0502	AS0602	AS1002
Input	Rated Control Voltage	90-265VAC							
	Pick-up Voltage	72VAC Minimum							
	Drop-out Voltage	60VAC Maximum							
	Input Current	15mA Maximum							
Output	Rated Load Voltage	90 - 240VAC							
	Peak Voltage	600V				800V			
	Rated Load Current	10A	20A	25A	30A	40A	50A	60A	100A
	Frequency	47 - 63Hz							
	Single Cycle Surge Current Resistance	170A	250A	315A			580A		
	Output Leakage Current (Maximum)	10mA	15mA						
	Output on Voltage Drop	1.5V Maximum							
	Minimum Switching Current	1A							
	Pick-up/Drop-out Time	1/2 cycle+1ms Maximum							

**AC Input / AC Output (90 - 480VAC)**

Model#	KMSR-	AS0104	AS0204	AS0254	AS0304	AS0404	AS0504	AS0604	AS1004
Input	Rated Control Voltage	90-265VAC							
	Pick-up Voltage	72VAC Minimum							
	Drop-out Voltage	60VAC Maximum							
	Input Current	15mA Maximum							
Output	Rated Load Voltage	90 - 480VAC							
	Peak Voltage	800V	1200V						
	Rated Load Current	10A	20A	25A	30A	40A	50A	60A	100A
	Frequency	47 - 63Hz							
	Single Cycle Surge Current Resistance	170A	250A	350A	370A	580A			
	Output Leakage Current (Maximum)	20mA							
	Output on Voltage Drop	1.3V MAX	1.6V MAX	1.8V Maximum					
	Minimum Switching Current	1A							
	Pick-up/Drop-out Time	1/2 cycle+1ms Maximum							

**Dimension**

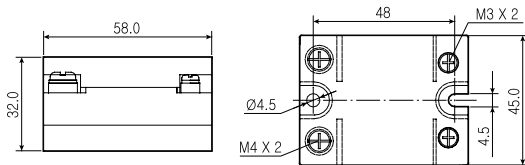

**Connection Diagram**

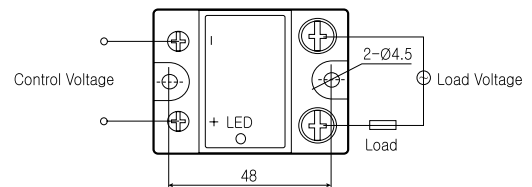

**Optional Heatsink**

**KSH-A040(25A-40A)**

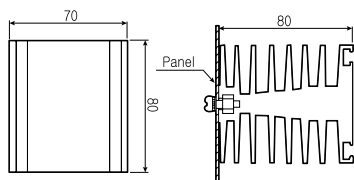

**KSH-A100(40A-100A)**

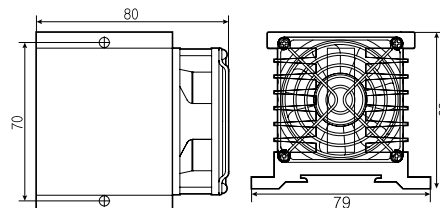

**Terminals**

